

# NelsonPine LVL P11: Span tables/charts

Lintels are beams contained with load bearing walls over windows or doors. They transfer the vertical loads applied over the opening to the jack studs on each side.

**BASIC LOADING DATA**  
 Wind Area = Very High  
 Snow Load, SG = 0.9kPa

Wind Design Strength Pressure = 1.5 kPa  
 Wind Serviceability Pressure = 1.1 kPa  
 Min. End Bearing Length = 35 mm  
 Service Class = Internal Protected

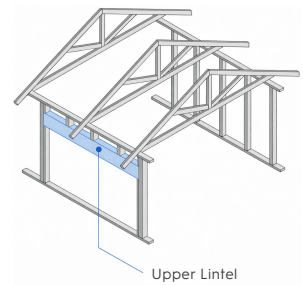

Uplift Fixings	
FIXING	CAPACITY
F	4.0 kN
G	7.5 kN
H	13.5 kN
SED	18.0 kN

**TABLE 1: LIGHT SHEET ROOF - WITH CEILING - 40KG/M2**

Roofing: Sheet (20kg/m<sup>2</sup>)  
 Ceiling: 13mm P'Board = (20kg/m<sup>2</sup>)

Version 2.0 - April 2026	Single Span: Hyne Design - Table 1					
NelsonPine LVL P11	Roof Load Width (m)					
Single Span	1.80	2.10	2.40	3.00	4.00	5.00
150 x 90	3200	3100	2900	2700	2400	2200
200 x 90	4000	3900	3800	3500	3200	3000
240 x 90	4600	4500	4300	4100	3800	3500
300 x 90	5400	5200	5100	4800	4400	4200
360 x 90	6200	6000	5800	5500	5100	4800*
400 x 90	6700	6400	6200	5900	5500*	5200*
610 x 90	8900	8700	8400	8000*	7500*	7000*

Table values relate to Allowable Maximum Span in mm

**TABLE 2: HEAVY TILE ROOF - WITH CEILING - 90KG/M2**

Roofing: Terracotta Tiles (70kg/m<sup>2</sup>)  
 Ceiling: 13mm P'Board = (20kg/m<sup>2</sup>)

Version 2.0 - April 2026	Single Span: Hyne Design - Table 2					
NelsonPine LVL P11	Roof Load Width (m)					
Single Span	1.80	2.10	2.40	3.00	4.00	5.00
150 x 90	2600	2400	2300	2200	1900	1800
200 x 90	3400	3200	3100	2900	2600	2400
240 x 90	3900	3700	3600	3400	3100	2900
300 x 90	4600	4400	4300	4000	3700	3500*
360 x 90	5200	5000	4900	4600	4300*	4000*
400 x 90	5700	5400	5300	5000*	4600*	4400*
610 x 90	7700*	7400*	7200*	6800*	6400*	6000*

Table values relate to Allowable Maximum Span in mm

\* Denotes member must have 2 Jack Studs at each supporting end

**Lintels are not designed for wind-face loading**

NelsonPine LVL P11 is an H1.2 treated engineered wood product consisting of radiata pine veneers laminated together to produce structural products. Feedstock is structural 45mm NelsonPine LVL subsequently secondary bonded into thicker 90mm product using PUR adhesive.

Spans have been derived from Hyne Design Software. If you require additional span details or alternative configurations/solutions, please refer to the **Hyne Design Software** for comprehensive structural timber design information: <https://www.nelsonpine.co.nz/product/lvl-design-fool-hyne/>